

MAUNU ROAD (SH14)

14.740m, 97° 11' 17"

18.000m, 97° 11' 17"

17.040m, 76° 54' 15"

6.300m, 168° 14' 20"

21/10/09
SK-01

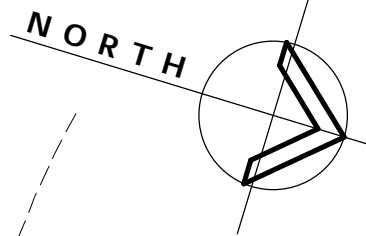
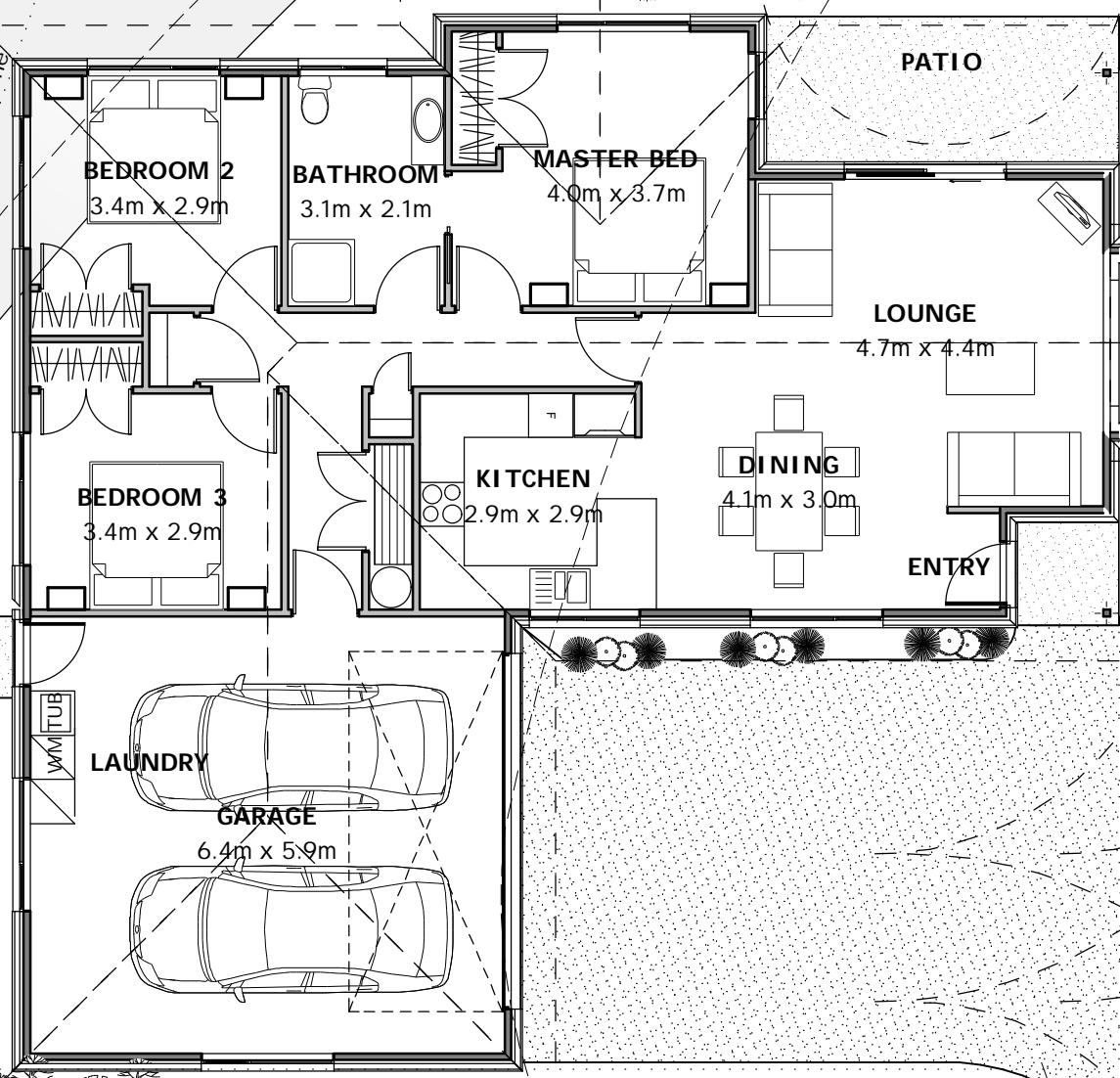

Contours @ 500mm intervals
LEGAL DESCRIPTION
LOT 1
DP 391301
AREA 835m²
SITE COVERAGE %
LIVING ENVIRONMENT 1
PUKENUI ESTATE
MAUNU

SITE PLAN
 SCALE 1:100

† S.S. CONNECTION
 † S.W. CONNECTION
 26.230m, 168° 14' 20"

WATER CONNECTION @ 0.000

PUKENUI ESTATE - LOT 1

PH: (09) 438 3779
 FAX: (09) 438 3778
NEWORLD DESIGN & BUILD LTD
 DISPLAY VILLAGE - 401 WESTERN HILLS DRIVE WHANGAREI
 PO BOX 391 WHANGAREI